



The Green, London

£1,075 PCM



the advantage of experience



- 1 double bed ground floor flat
- Great location on The Green
- Bathroom with bath and shower
- 2 patio areas
- Through lounge/kitchen/diner
- Furnished



For more images of this property please visit havilands.co.uk

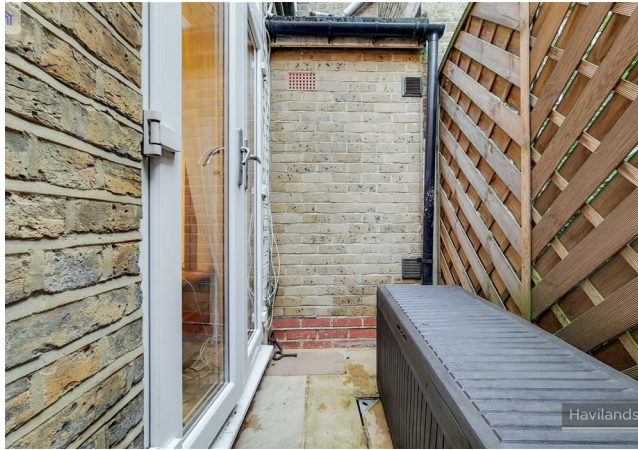

Havilands are delighted to present this ground floor, 1 bed flat with 2 patio areas in the heart of Winchmore Hill Green and moments walk from the mainline station (30 mins to Moorgate). The apartment sits in a quiet location to the rear of the building. The lounge, which benefits from patio doors leading to a patio; leads into a kitchen/dining area. The bathroom benefits from both a bath and shower cubicle. To the rear of the flat is a double bedroom with a door leading to the second patio. The flat is situated close of the restaurants, delis, shops and pubs around The Green. The property comes fully furnished and is available end November/beginning December.

For more images of this property please visit havilands.co.uk

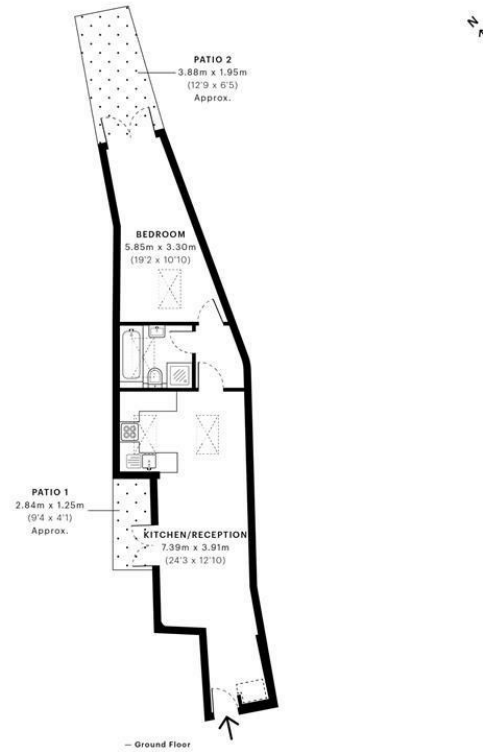

GROSS INTERNAL AREA (GIA)
The footprint of the property
47.72 sqm / 513.65 sqft

NET INTERNAL AREA (NIA)
Excludes walls and external features
Includes mezzanine, restricted head height
46.53 sqm / 500.84 sqft

EXTERNAL STRUCTURAL FEATURES
Balconies, terraces, verandas, etc.
0.00 sqm / 0.00 sqft

RESTRICTED HEAD HEIGHT
Listed use area under 1.8m
0.71 sqm / 7.64 sqft



Spec Verified floor plans are produced in accordance with Royal Institution of Chartered Surveyors' Property Measurement Standards. Plots and gardens are illustrative only and excluded from all area calculations. Due to rounding, numbers may not add up precisely. All measurements shown for the individual room lengths and widths are the maximum points of measurements captured in the scan.

IPNS 38 RESIDENTIAL 47.72 sqm / 513.65 sqft
IPNS 30 RESIDENTIAL 46.53 sqm / 500.84 sqft
srpc id: 615f10b6c7edde0d5966c4d1

havilands | 020 8886 6262
come by and meet the team
30 The Green, Winchmore Hill, London, N21 1AY



the advantage of experience